

Modula Quick Start Guide



INTRODUCTION

CREO Modula is a highly adaptive and flexible scanning solution, producing fully encoded scan image using standard UT probes. Due to the modular construction CREO Modula can be used for a host of different scanning applications.

This kit has been supplied with:

Stud scanning attachment
(1 5/8" to 3" studs)

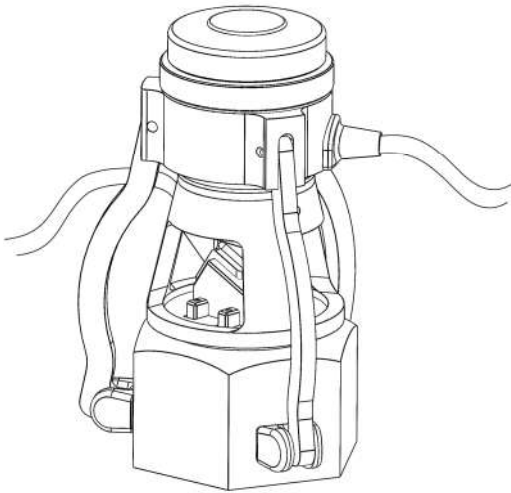

Face scanning up to
400mm diameter

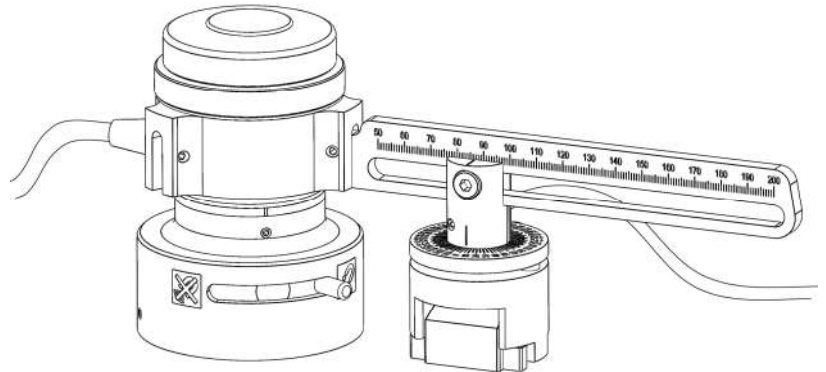

About the encoder -

The encoder assembly has an internal mechanism which is linked to the 3 slots around the diameter. This allows the 3 legs to be located on different diameters. To do this simply turn the adjusting wheel.

Scanning wheel

Adjusting wheel

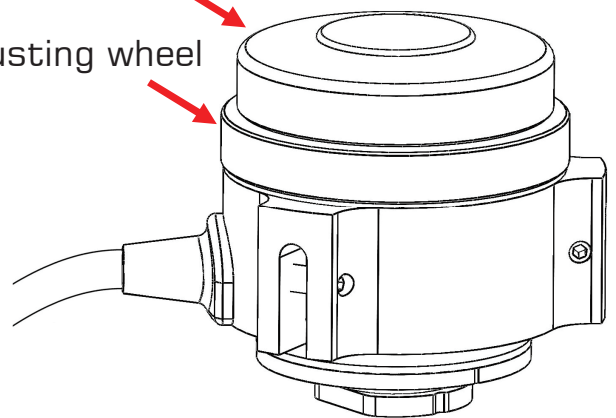

This wheel will also allow you to set the slide for face scanning, as described later in this booklet. When the scanning wheel is rotated this operates the encoder and also rotates the probe and probe basket.

WHAT'S IN THE BOX?

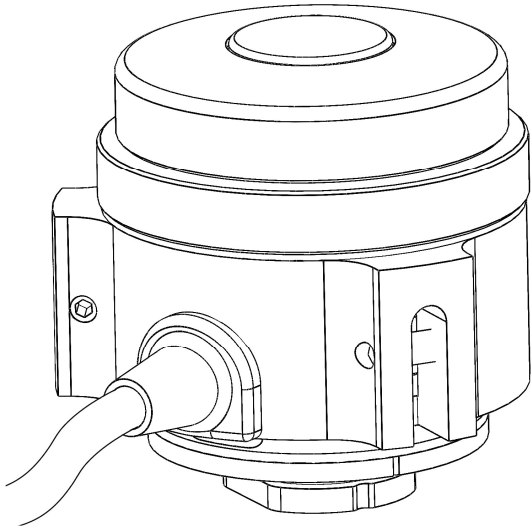

1x Encoder Head
Part No: X0512

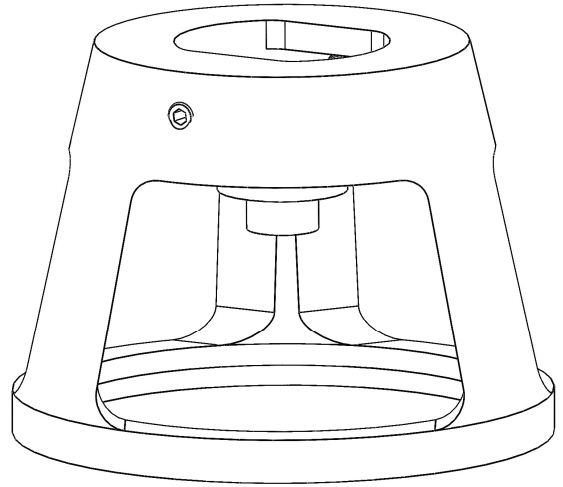

1x Probe Basket
Part No: X0510

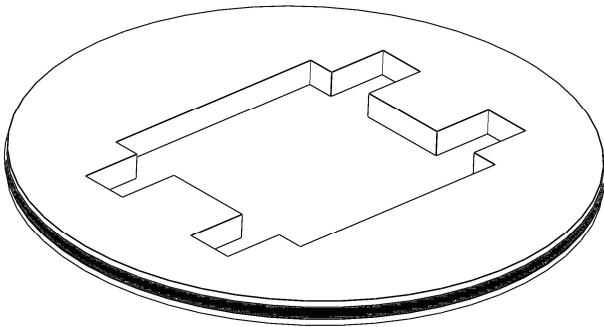

1x Probe Plate (Centre)
Part No: X0511-1

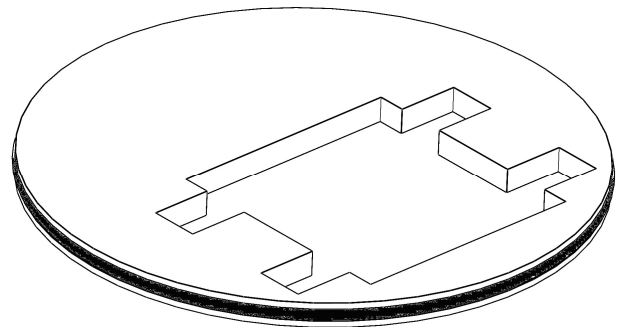

1x Probe Plate (10mm Offset)
Part No: X0511-2

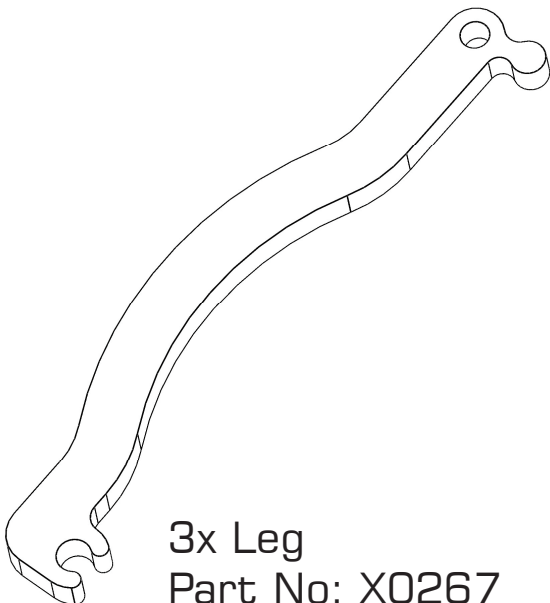

3x Leg
Part No: X0267

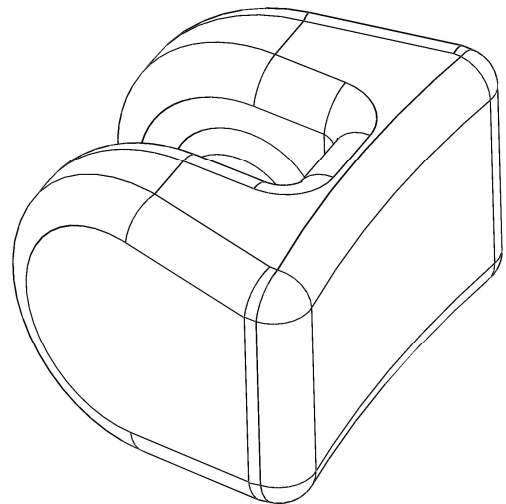

3x Rubber Foot
Part No: X0393

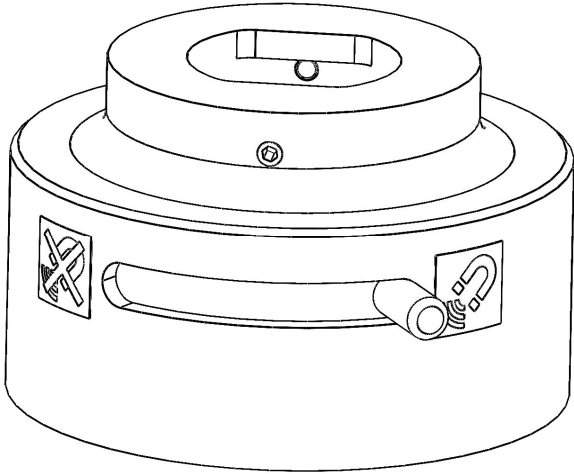

1x Magnetic Base
Part No: X0403

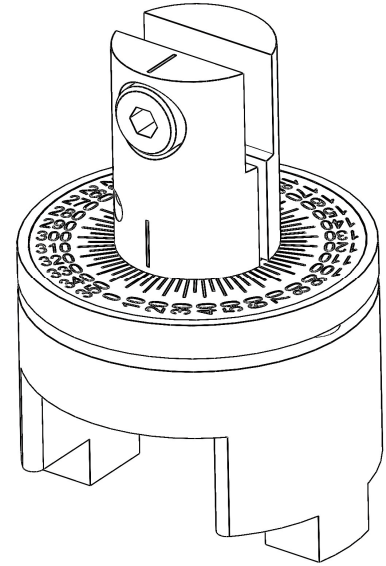

1x Probe Holder
Part No: X0513

1x Linear Slide
Part No: X0443

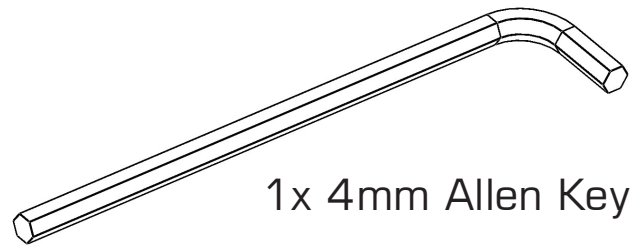
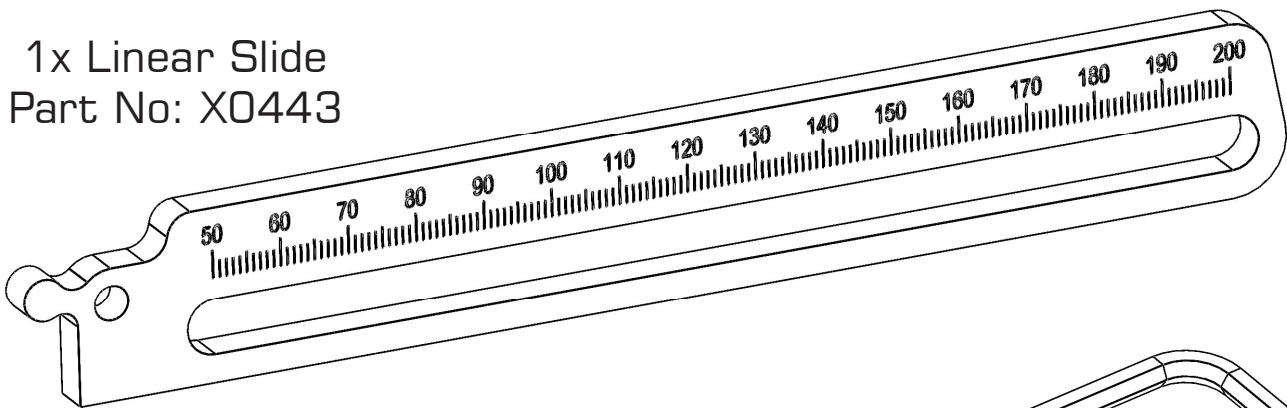

1x 4mm Allen Key

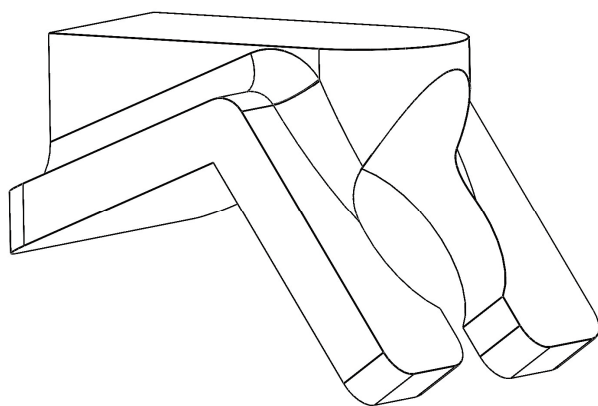

1x Pressure Pad
Part No: X0515

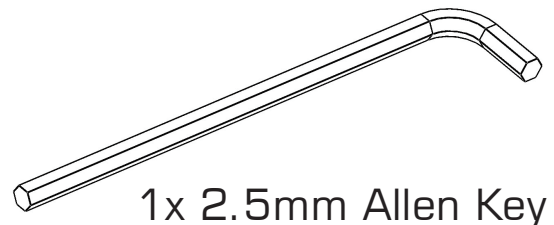

1x 2.5mm Allen Key

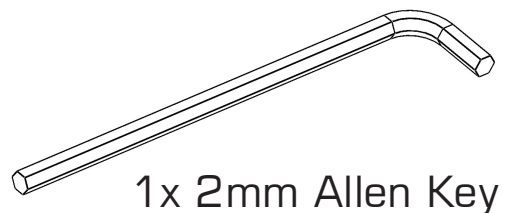

1x 2mm Allen Key

SETTING UP STUD SCANNER

1 — Attach the probe basket

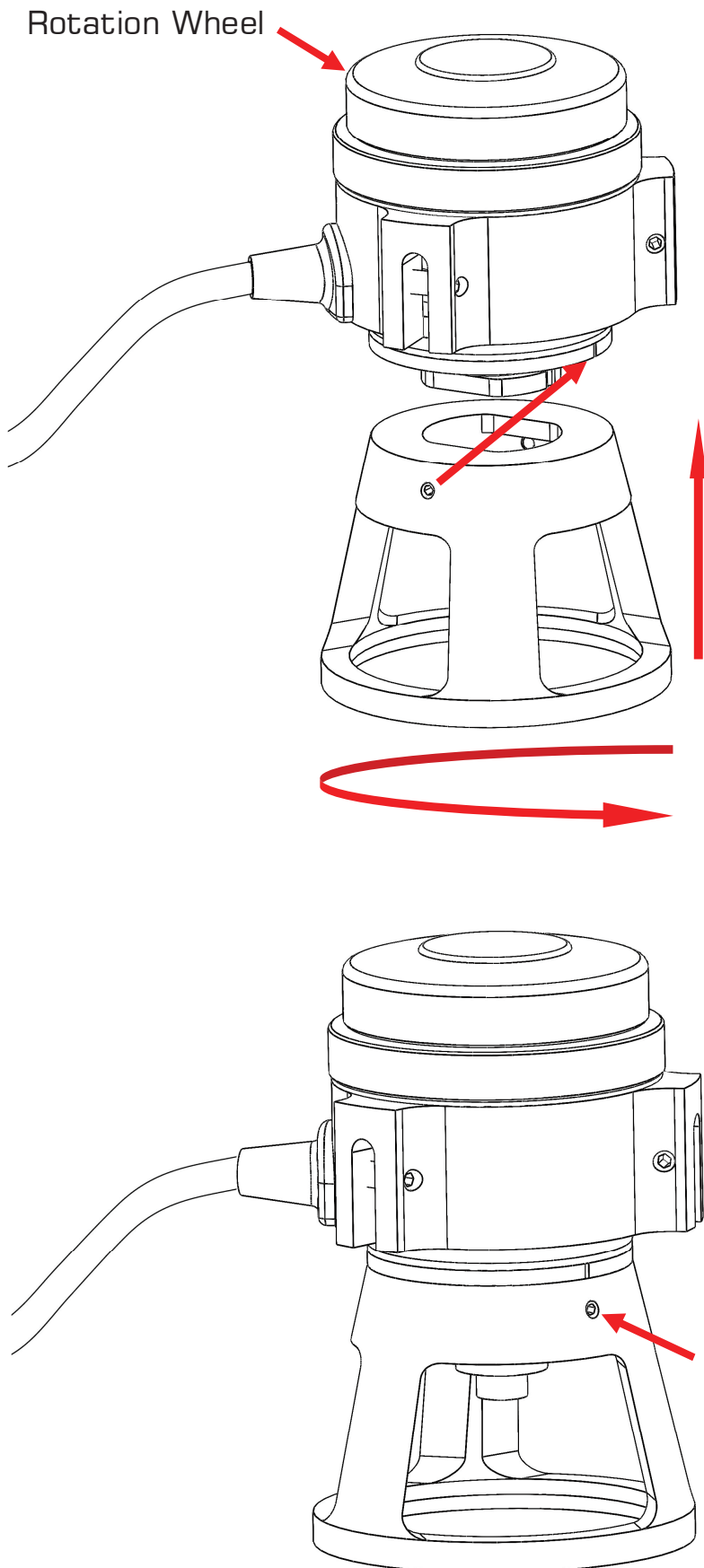

Locate the probe basket onto the encoder housing as shown.

While holding the rotation wheel turn the probe basket through 90° until the locking screw and the ident mark align, you will also feel the detent in the basket engaging with the groove on the encoder.

Using the 2mm Allen key provided, tighten the locking screw to prevent the basket becoming detached during use.

2 — Attach the probe plate

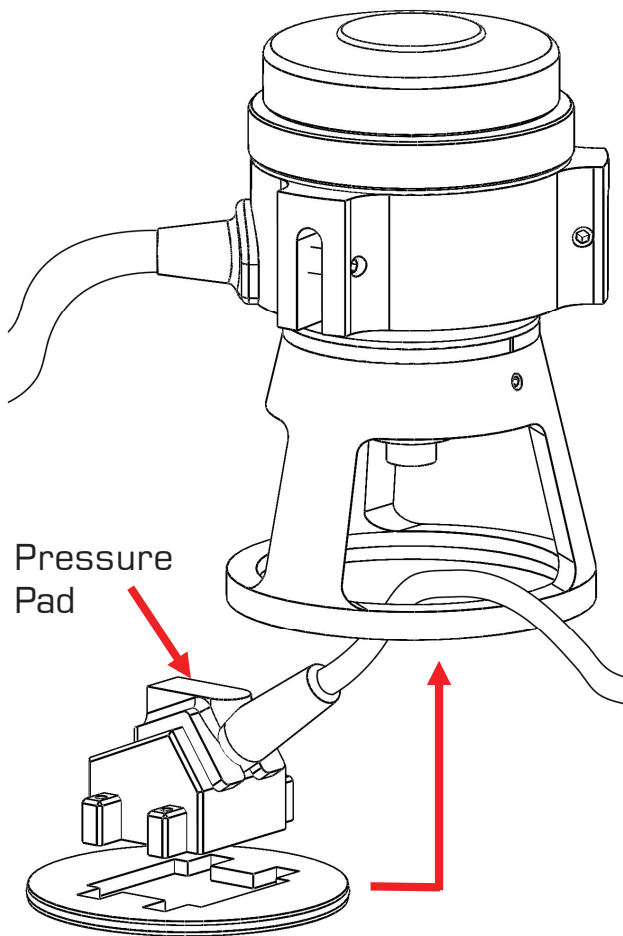

Pass the probe and cable through the basket window as shown.

Press the probe plate into the base of the probe basket allowing the probe to project through the aperture.

Please note the pressure pad must be fitted to the top of the probe allowing the spring plunger to affect force to the probe.

3 — Attach the legs and feet

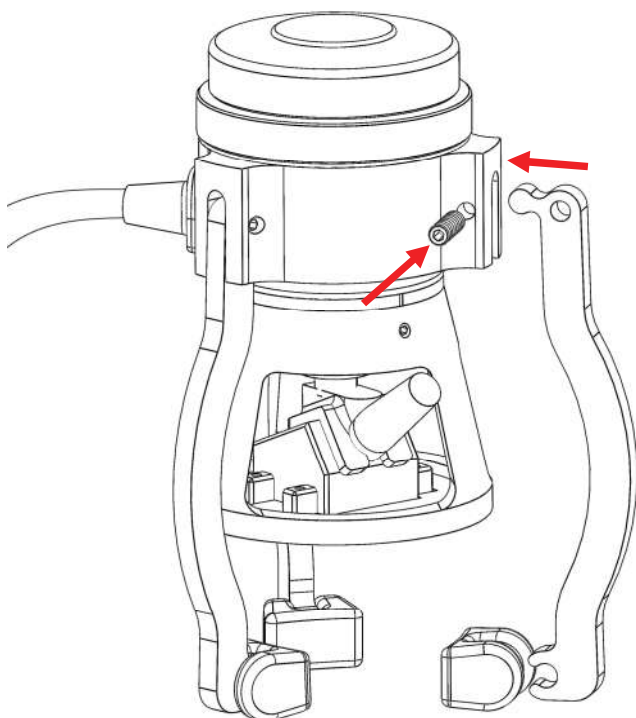

Using the 2.5mm Allen key provided remove the pivot screw and slot the leg into place.

Ensure the lobe locates into the internal adjuster slot.

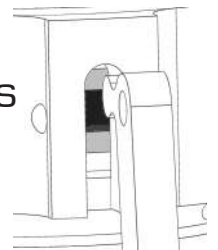

Replace the pivot screw to secure the leg into place. Note, there should be no resistance if you feel the screw tightening please remove and re seat the leg.

Clip rubber feet into place on the end of each leg.

SETTING UP FACE SCANNER

1 — Attach the magnetic base

Rotation Wheel

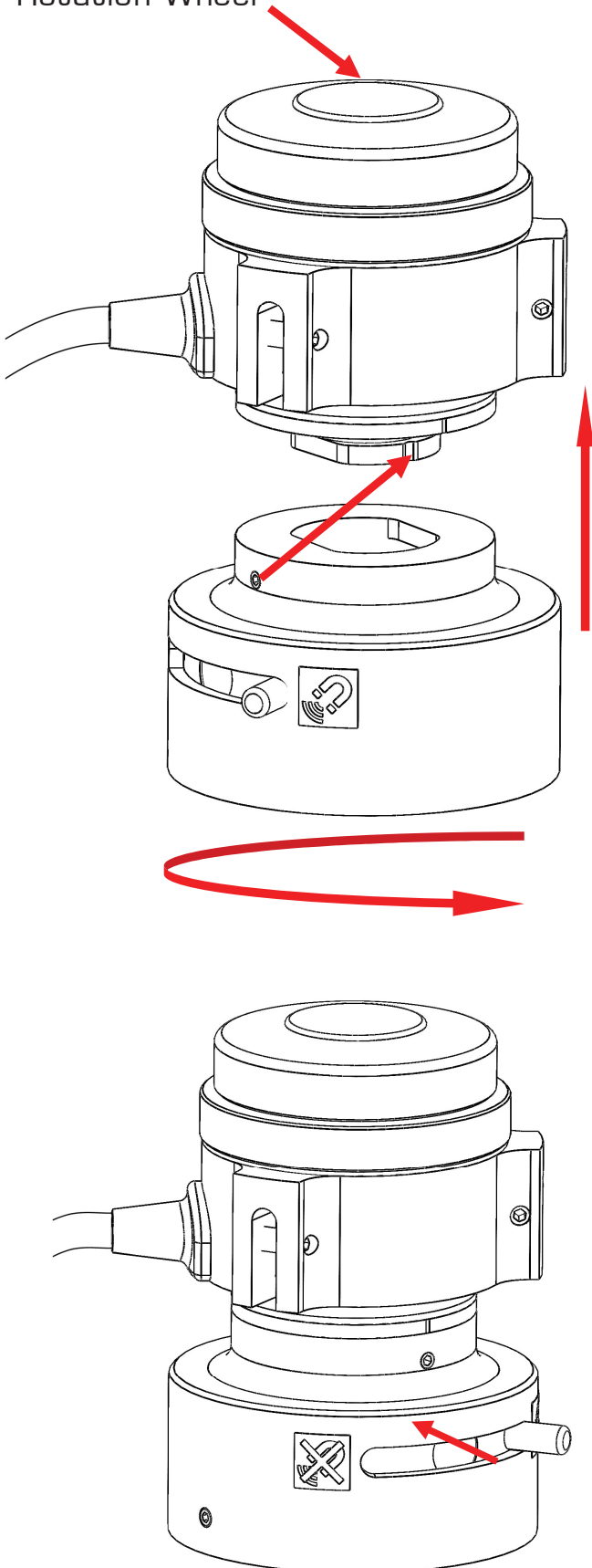

Locate the magnetic base onto the encoder housing as shown.

While holding the rotation wheel turn the magnetic base through 90° until the locking screw and the ident mark align, you will also feel the detent in the magnet engaging with the groove on the encoder.

Using the 2mm Allen key provided, tighten the locking screw to prevent the magnet becoming detached during use.

2 — Attach the linear slide

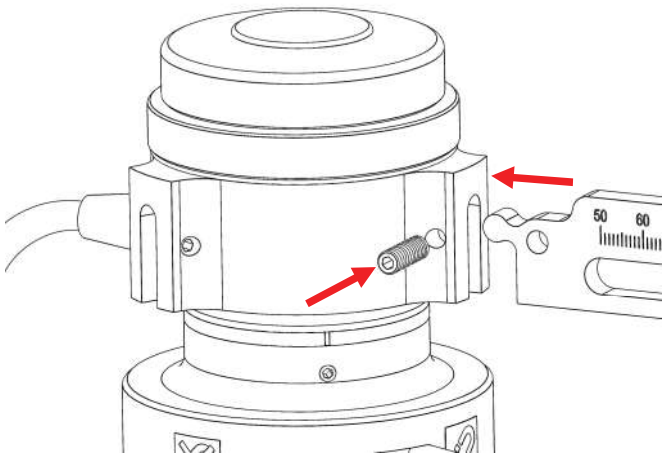

Using the 2.5mm Allen key provided remove the pivot screw and slot the linear slide into place. Ensure the lobe locates into the internal adjuster slot. Replace the pivot screw to secure the leg into place. Note, there should be no resistance if you feel the screw tightening please remove and re seat the linear slide.

3 — Attach the probe holder

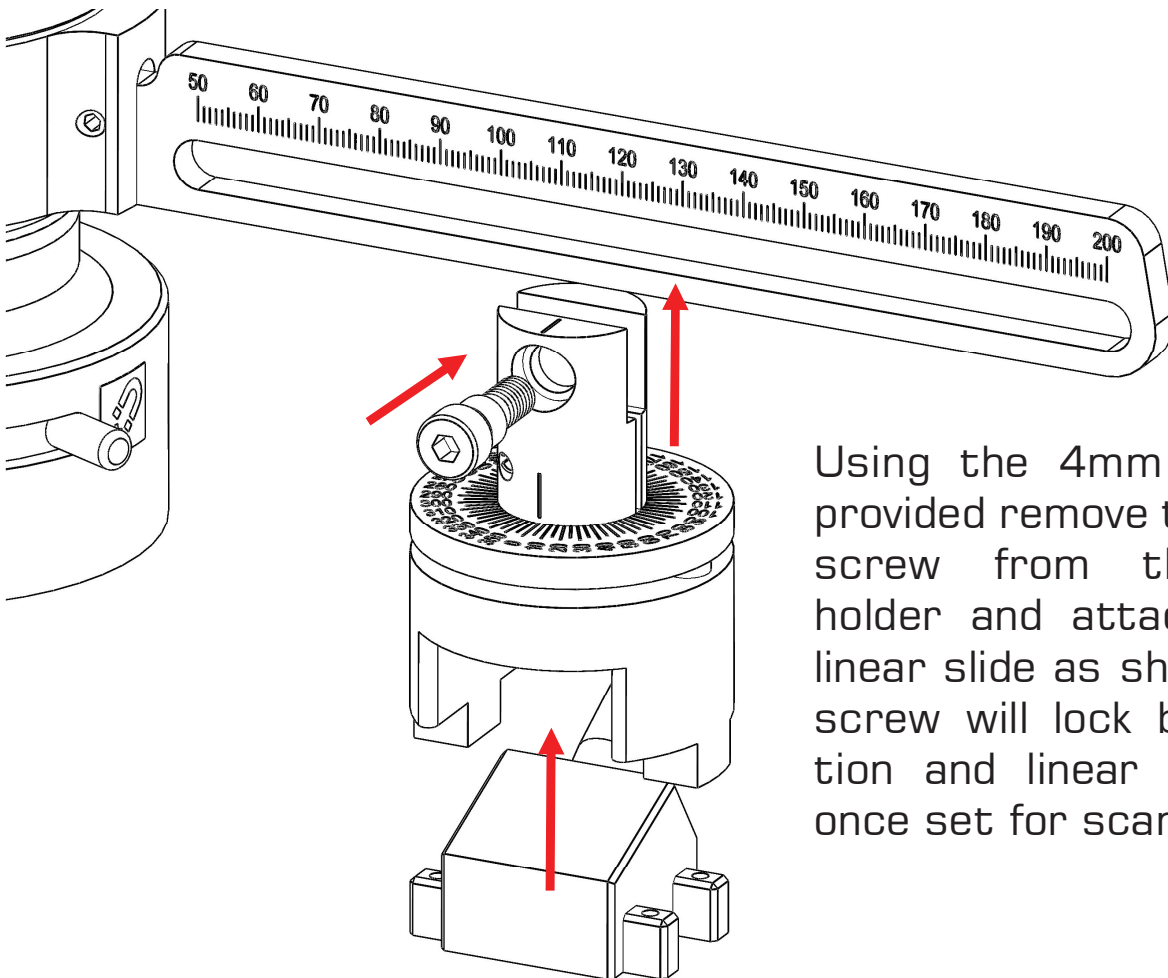

Using the 4mm Allen key provided remove the locking screw from the probe holder and attach to the linear slide as shown. This screw will lock both rotation and linear movement once set for scanning.

The probe locates under the holder as shown. You will need to adjust the angle of the linear slide to set it parallel to the scanning surface. To do this use the adjusting wheel as described on page 1.